



# HARWICH SEWER CONNECTION

PRESENTED BY  
COASTAL ENGINEERING COMPANY, INC.



## SEAN RILEY VICE PRESIDENT

- REGISTERED PROFESSIONAL ENGINEER, CERTIFIED FLOODPLAIN MANAGER
- 22 YEARS OF EXPERIENCE IN CIVIL ENGINEERING
- SPECIALIZATIONS: SITE ANALYSIS AND LAYOUT, WASTEWATER TREATMENT & STORMWATER MANAGEMENT SYSTEMS DESIGN, CONSTRUCTION ADMINISTRATION
- IN-DEPTH KNOWLEDGE OF FEDERAL, STATE AND LOCAL REGULATIONS



- REGISTERED PROFESSIONAL ENGINEERS AND LAND SURVEYORS
- SERVING CAPE COD & ISLANDS FOR 42 YEARS
- OFFICES IN ORLEANS, SANDWICH, AND NANTUCKET
- EXPERTS IN WASTEWATER TREATMENT SYSTEMS DESIGN
- RECENT SEWER CONNECTION PROJECT: CHATHAM

# TOPICS COVERED

- TOWN SEWER PROJECT OVERVIEW & TIMELINE
- TOWN PLANS & LIMITS OF WORK
- SEWER CONNECTION PROCESS
- BENEFITS OF NEIGHBORHOOD COORDINATION
- OUR SERVICES
- NEXT STEPS
- QUESTIONS?

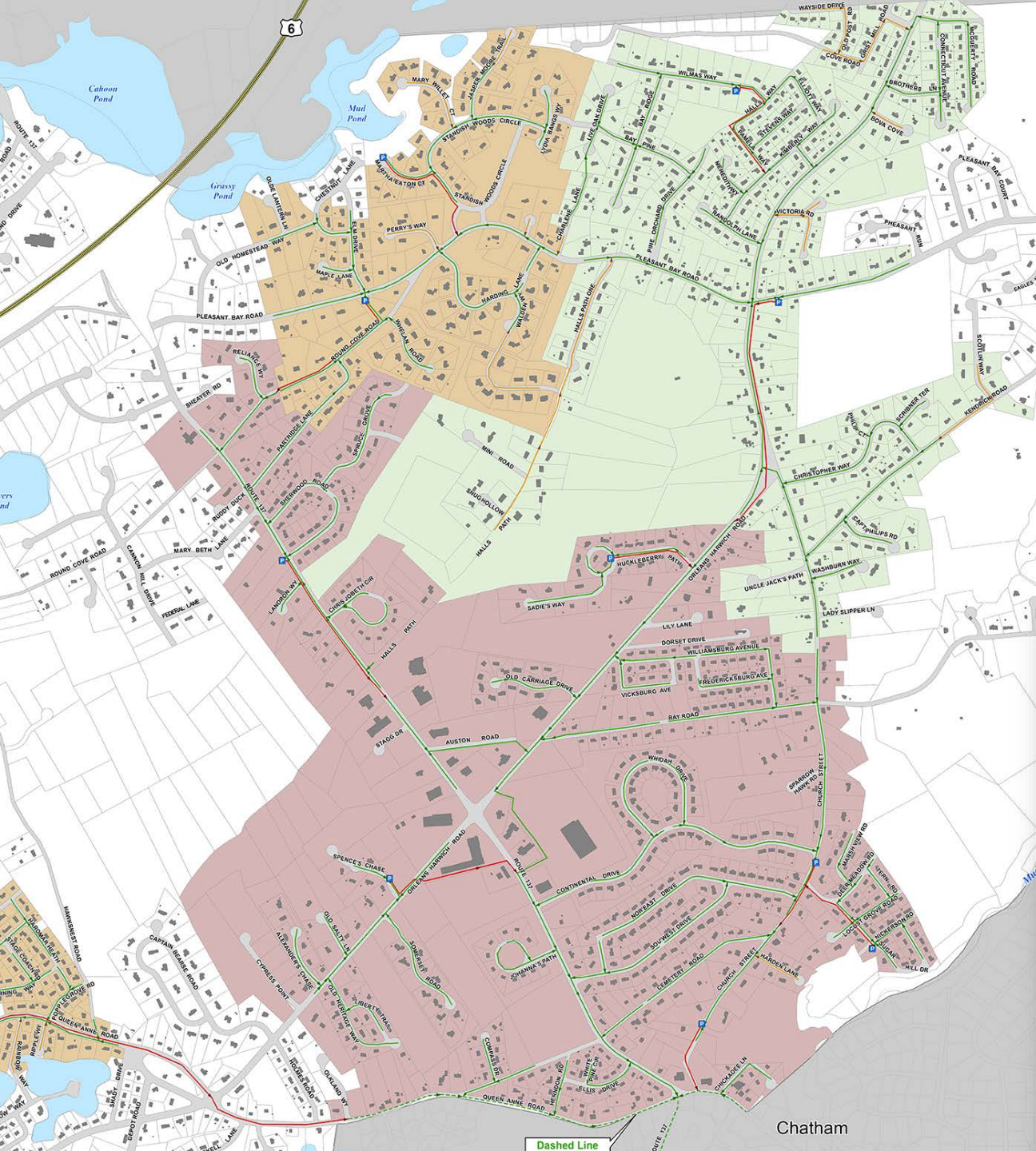

# PROJECT OVERVIEW

## Conceptual East Harwich Sewer Service Area



- | Sewershed Phase | Sewer Mains     |
|-----------------|-----------------|
| Phase 2         | Force Main      |
| Phase 3         | Pressure Sewer  |
| Phase 8         | Gravity Sewer   |
|                 | Pumping Station |

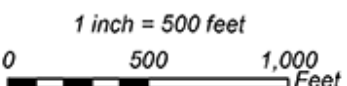

Dashed Line

Chatham

# PROJECT TIMELINE

## Town of Harwich Sewer - Phase2 Timeline

Design	Ongoing – January 2019 Engage engineers now!
Bidding Process	January 2019 – May 2019
Construction of Town Sewers	May 2019 – May 2021
Homeowners Begin Connecting	June 2021 – June 2022
Flow Begins to Chatham Facility	June 2021

# Conventional Septic System

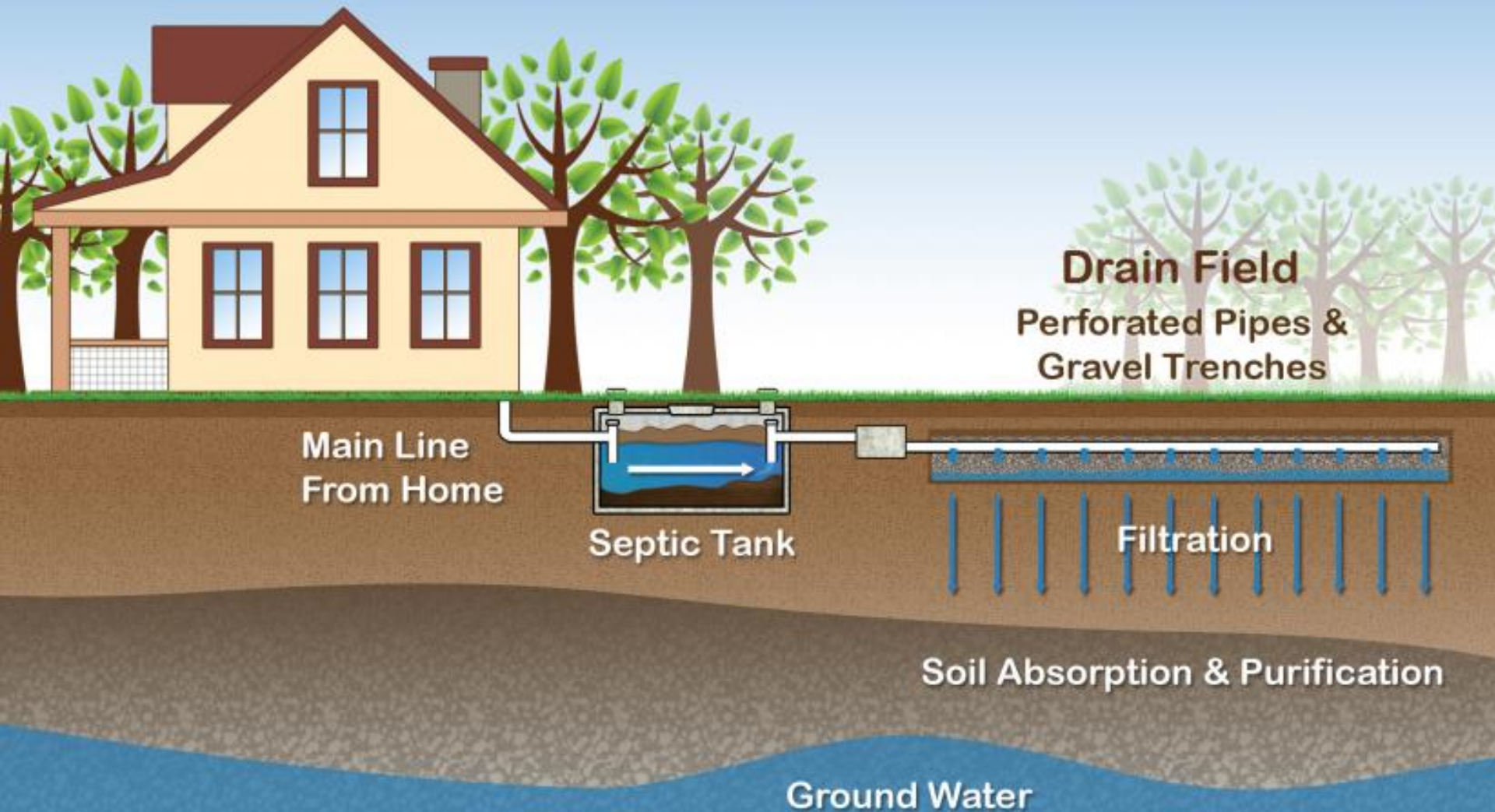

# OBLIGATIONS: TOWN AND PROPERTY OWNERS

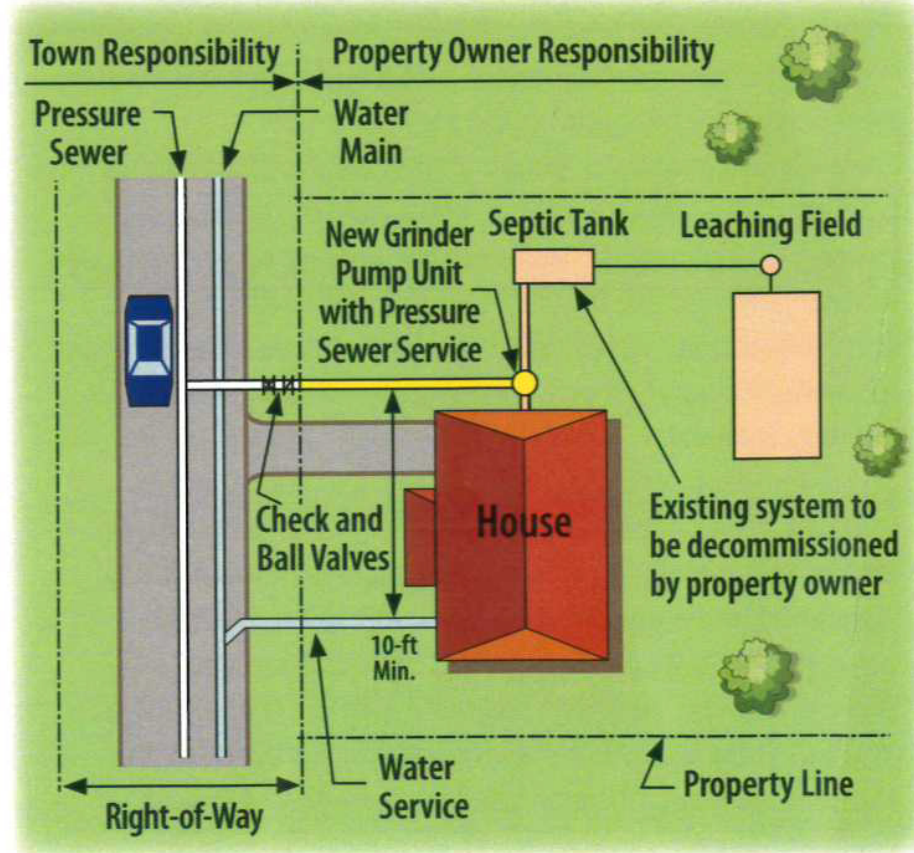
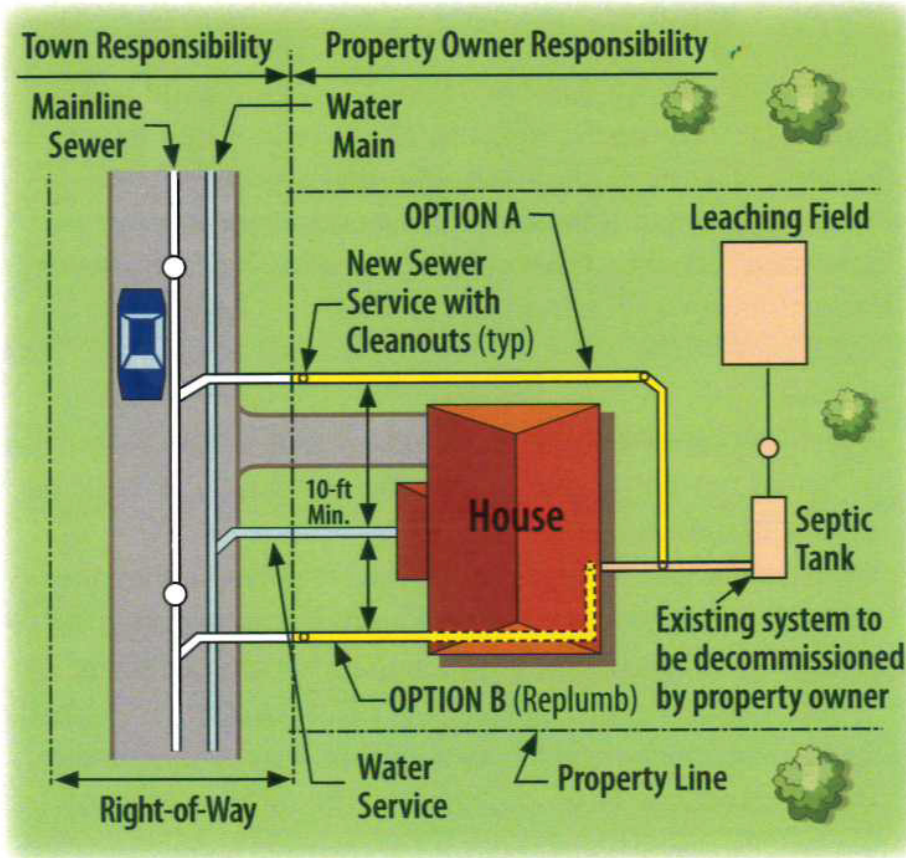

Potential Gravity Pipe House Connection

Potential Pressure Pipe House Connection



# SEWER CONNECTION

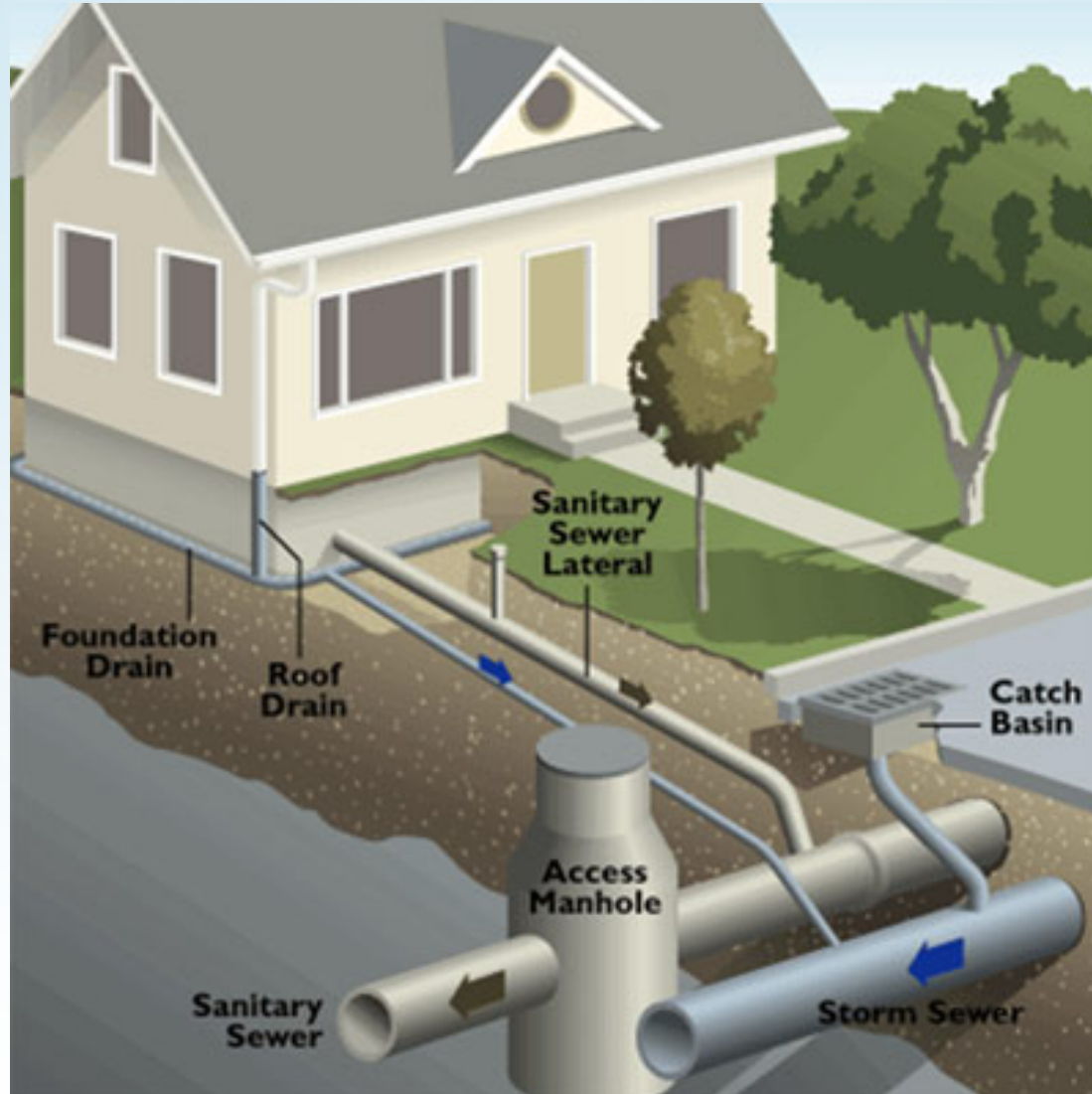

# COASTAL ENGINEERING PLAN

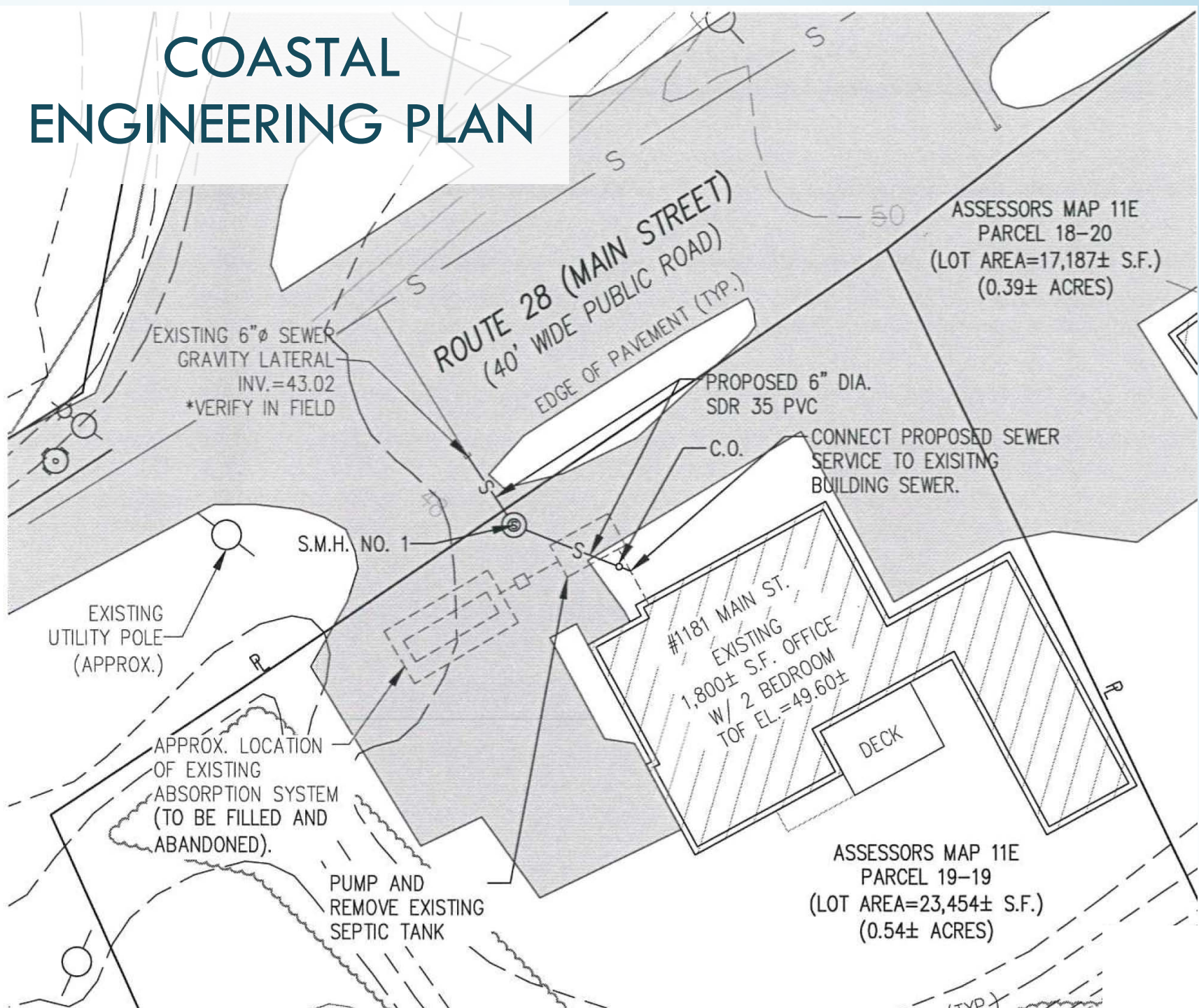

# TOWN PLANS

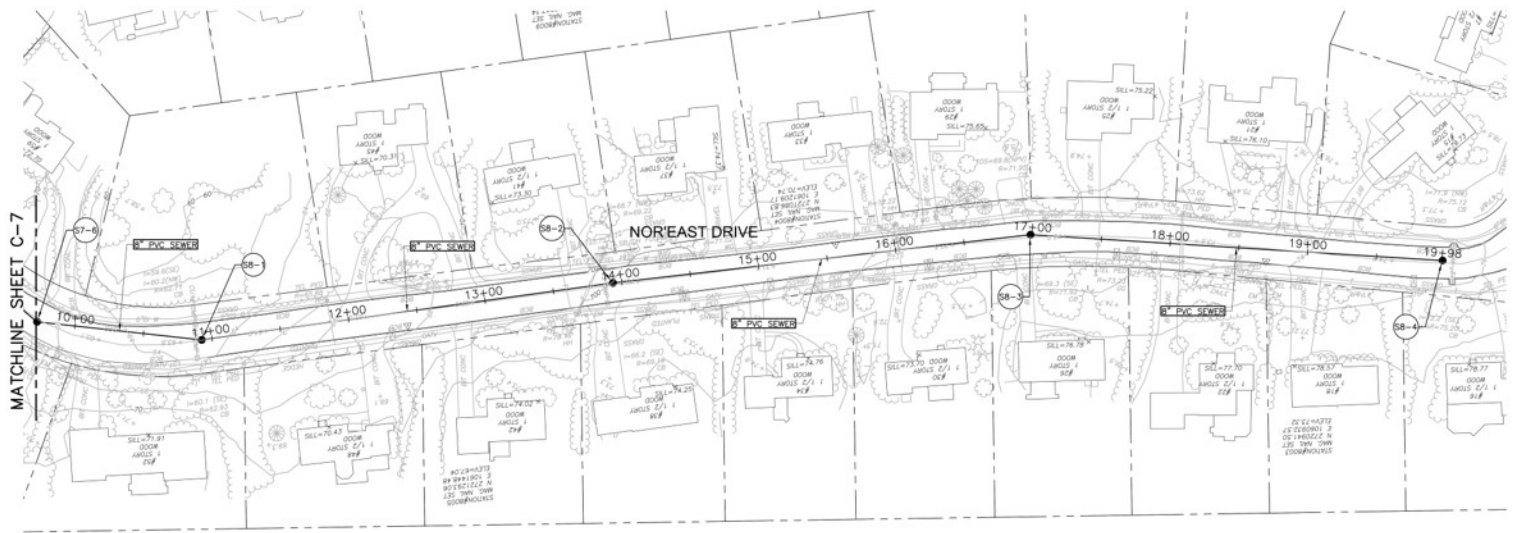

NOR'EAST DRIVE  
PLAN  
1"=40'

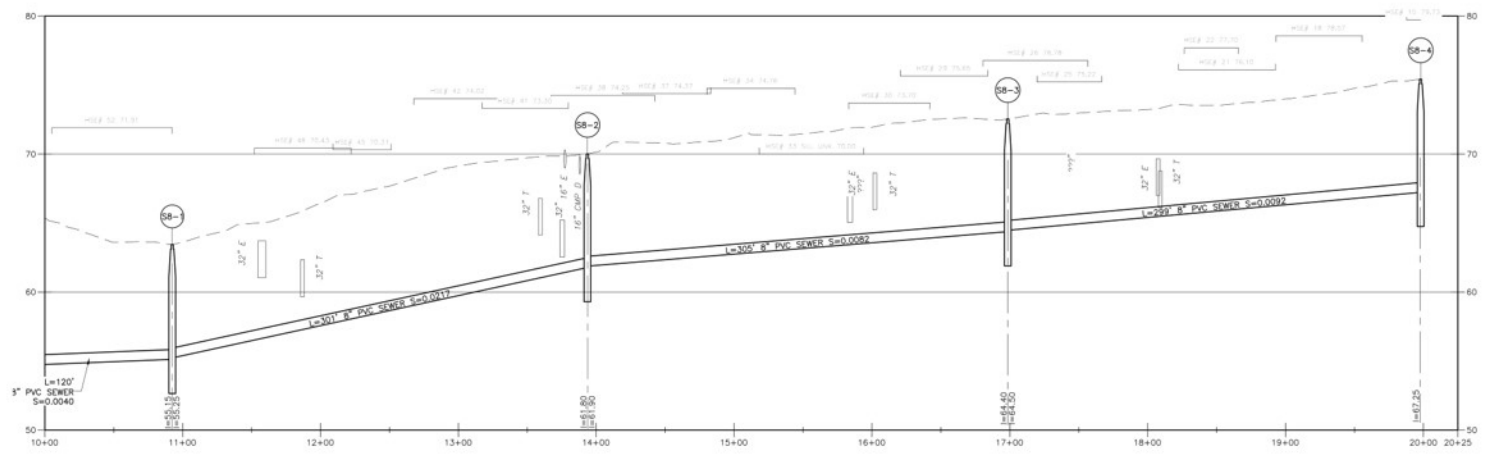

PROFILE  
HOR: 1"=40'  
VERT: 1"=4'

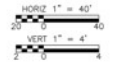

PROGRESS PRINT - 6-20-2018

REV	DATE	DRWN	CHKD	REMARKS

DESIGNED BY: \_\_\_\_\_ X  
 DRAWN BY: S. ENGLER  
 CHECKED BY: \_\_\_\_\_ X  
 CROSS CHECKED BY: \_\_\_\_\_ X  
 APPROVED BY: \_\_\_\_\_ X  
 DATE: JUN 2018



50 Hampshire Street  
 Cambridge, MA 02139  
 Tel: (617) 452-6000

TOWN OF HARWICH, MASSACHUSETTS  
 SEWERAGE WORKS IMPROVEMENTS  
 PHASE 2 - CONTRACT NO. 2

NOR'EAST DRIVE

PROJECT NO. 0324-113964  
 FILE NAME: C008R1018  
 SHEET NO. C-8



# BENEFITS OF NEIGHBORHOOD COORDINATION

- ECONOMY OF SCALE COST SAVINGS  
IN ENGINEERING DESIGN AND CONSTRUCTION
- BETTER CONSTRUCTION COORDINATION



# BENEFITS OF HIRING COASTAL ENGINEERING

- PROACTIVE DESIGN
- MINIMIZE CONSTRUCTION COST
- OPTIONAL ASSISTANCE DURING CONSTRUCTION PHASE

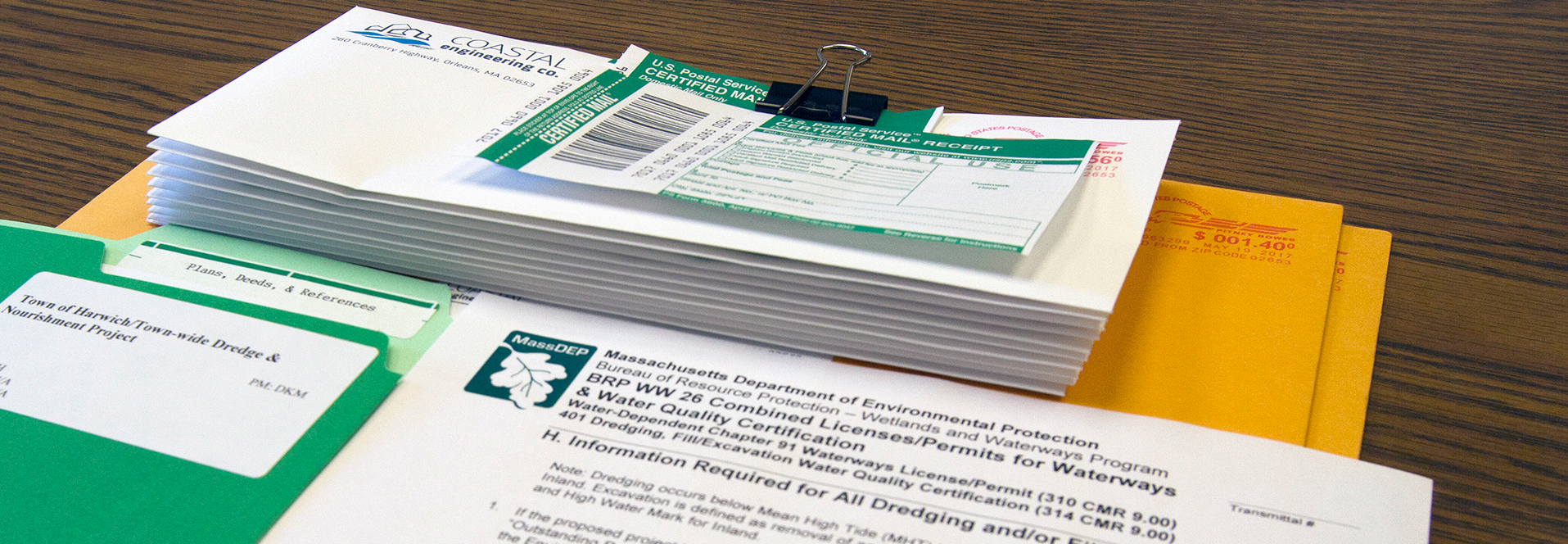

# OPTIONAL: PERMITTING COORDINATION

- SEWER DEPARTMENT: CONNECTION PERMIT
- BOARD OF HEALTH: TITLE 5 ABANDONMENT PERMIT
- CONSERVATION COMMISSION (IF NECESSARY)

# OPTIONAL: CONSTRUCTION PHASE SERVICES

- CONTRACTOR BIDDING
- CONTRACTOR SELECTION
- PERMIT COORDINATION
- PROJECT OVERSIGHT AND CLOSEOUT



# NEXT STEPS

- TALK TO YOUR NEIGHBORS AND FIND OUT WHO IS INTERESTED IN CONTRACTING COASTAL ENGINEERING TOGETHER
- VISIT [COASTALENGINEERINGCOMPANY.COM/HARWICH-SEWER:](https://coastalengineeringcompany.com/harwich-sewer)
  - DOWNLOAD SLIDES
  - WATCH PRESENTATION
  - REQUEST A PROPOSAL
- ENGAGE ENGINEER TO ASSESS THE EXISTING SITE CONDITIONS FOR OPTIMAL LOCATION OF SEWER TIE-IN
- PREPARE PLANS FOR PERMIT AND CONSTRUCTION



# THANK YOU!

VISIT [COASTALENGINEERINGCOMPANY.COM/HARWICH-SEWER](https://www.coastalengineeringcompany.com/harwich-sewer) TO:

- REQUEST A PROPOSAL
- DOWNLOAD SLIDES
- WATCH PRESENTATION