

# CAPE COD REGIONAL TECHNICAL HIGH SCHOOL

Harwich, MA

Cape Cod Regional Technical High School is a 214,000 SF building located on a 67-acre site. The existing facility, originally constructed in 1975 with the "open" concept approach to instruction, does not meet current minimum classroom size, technology, and accessibility requirements. In addition, the school's electrical, heating and cooling systems are outdated. After several options were presented to the District including base repair options, addition/renovation configurations, and new construction options, the voters decided to proceed with construction of a new building, which will group academic spaces around each technical discipline to foster a sense of collaboration.

Coastal Engineering Co. has been working with Drummey Rosane Anderson architects to provide civil engineering and surveying services in connection with feasibility study and design of the new high school, which will be 6,000 SF larger than the current building and will house 650 students. The new building will provide two wings of academic classrooms, a large space for vocational shops, and additional height and access for the construction and transportation shops. The design includes 22 general classrooms, 2 small group/flex spaces, 6 science classroom/labs, 2 art/maker spaces, 17 vocational/technical shops/classrooms, and a gym.

Featuring three stories, the new school is designed to fit into the topography along the eastern edge of the property. When it's ready for use in 2021, the old school will be demolished to make room for parking and new sports fields.

## SERVICES

- Existing conditions survey of a 67 acre parcel of land
- Preparation of an existing conditions site plan
- Civil engineering design and site plan of new sewage disposal, stormwater drainage, and erosion/sedimentation control systems, as well as utilities
- Preparation of plans and specifications for public bid procurement

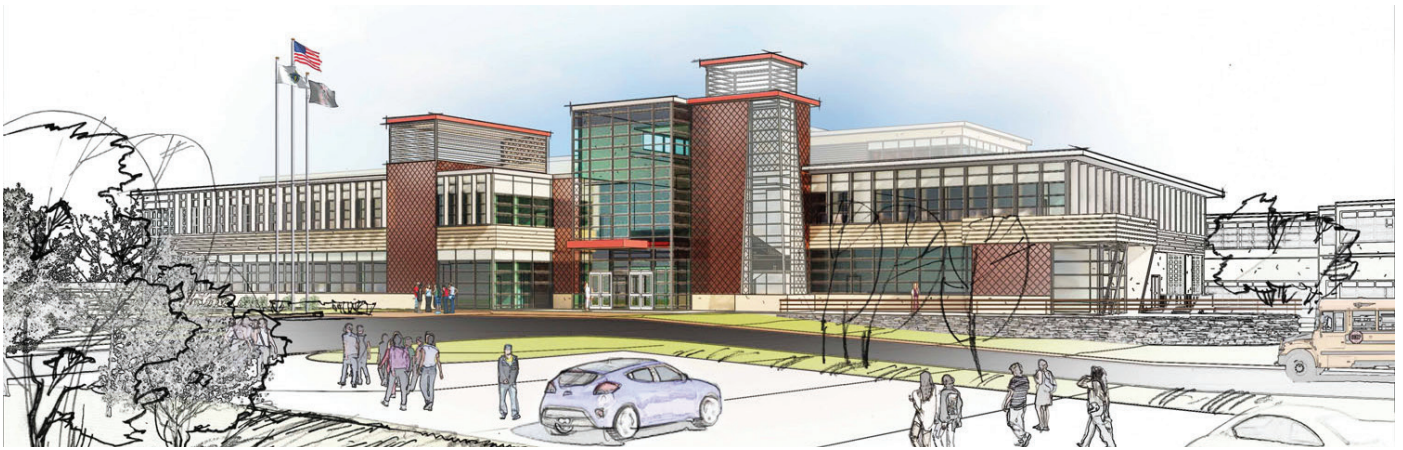

Renderings by Drummey Rosane Anderson, Inc.